



VÁLVULAS DE MEMBRANA EN PVC-U  
PVC-U DIAPHRAGM VALVES  
VANNE À MEMBRANE EN PVC-U

**VÁLVULAS DE MEMBRANA EN PVC-U PN 10 bar** - Membrana de EPDM o FPM  
**PVC-U DIAPHRAGM VALVES NP 10 bar** - EPDM or FPM Diaphragm  
**VANNE À MEMBRANE EN PVC-U PN 10 bar** - Membrane de EPDM ou FPM

**Manguitos encolar**  
**Socket ends**  
**Raccords à coller**

| CODIGO  | TUBO Ø | Kg.   | DN |
|---------|--------|-------|----|
| 2610016 | 16     | 0,428 | 10 |
| 2610020 | 20     | 0,426 | 15 |
| 2610025 | 25     | 0,535 | 20 |
| 2610032 | 32     | 0,760 | 25 |
| 2610040 | 40     | 1,015 | 32 |
| 2610050 | 50     | 1,594 | 40 |
| 2610063 | 63     | 1,929 | 50 |



Membrana de FPM  
FPM Diaphragm  
Membrane de FPM

FPM

| CODIGO  |
|---------|
| 2616016 |
| 2616020 |
| 2616025 |
| 2616032 |
| 2616040 |
| 2616050 |
| 2616063 |

FPM = Caucho fluorcarbonado

**Manguitos rosca hembra BSP**  
**BSP female threaded ends**  
**Taraudée BSP femelle**

| CODIGO  | TUBO Ø | Kg.   | DN |
|---------|--------|-------|----|
| 2620016 | 3/8"   | 0,430 | 10 |
| 2620020 | 1/2"   | 0,424 | 15 |
| 2620025 | 3/4"   | 0,535 | 20 |
| 2620032 | 1"     | 0,756 | 25 |
| 2620040 | 1 1/4" | 1,001 | 32 |
| 2620050 | 1 1/2" | 1,610 | 40 |
| 2620063 | 2"     | 1,974 | 50 |



Membrana de FPM  
FPM Diaphragm  
Membrane de FPM

FPM

| CODIGO  |
|---------|
| 2626016 |
| 2626020 |
| 2626025 |
| 2626032 |
| 2626040 |
| 2626050 |
| 2626063 |

FPM = Caucho fluorcarbonado

**Con bridas PN 10 bar**  
**With NP 10 bar flanges**  
**Avec brides PN 10 bar**

| CODIGO  | TUBO Ø | Kg.   | DN |
|---------|--------|-------|----|
| 2630020 | 20     | 0,578 | 15 |
| 2630025 | 25     | 0,775 | 20 |
| 2630032 | 32     | 1,040 | 25 |
| 2630040 | 40     | 1,423 | 32 |
| 2630050 | 50     | 1,884 | 40 |
| 2630063 | 63     | 2,381 | 50 |



Membrana de FPM  
FPM Diaphragm  
Membrane de FPM

FPM

| CODIGO  |
|---------|
| 2636020 |
| 2636025 |
| 2636032 |
| 2636040 |
| 2636050 |
| 2636063 |

FPM = Caucho fluorcarbonado



VÁLVULAS DE MEMBRANA EN PVC-U  
 PVC-U DIAPHRAGM VALVES  
 VANNE À MEMBRANE EN PVC-U

CARACTERÍSTICAS TÉCNICAS - TECHNICAL CHARACTERISTICS - CARACTÉRISTIQUES TECHNIQUES

VÁLVULAS DE MEMBRANA - DIAPHRAGM VALVES - VANNE À MEMBRANE

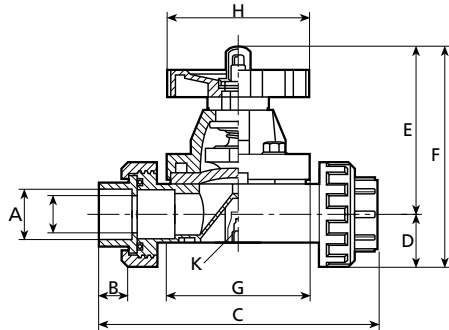

| Ø  | A  | B  | C   | D  | E   | F   | G   | H   | I  | K   |
|----|----|----|-----|----|-----|-----|-----|-----|----|-----|
| 16 | 16 | 17 | 156 | 24 | 93  | 117 | 73  | 82  | 10 | M-6 |
| 20 | 20 | 17 | 156 | 24 | 93  | 117 | 73  | 82  | 15 | M-6 |
| 25 | 25 | 19 | 168 | 27 | 98  | 125 | 83  | 82  | 20 | M-6 |
| 32 | 32 | 22 | 184 | 33 | 107 | 140 | 93  | 94  | 25 | M-6 |
| 40 | 40 | 27 | 205 | 39 | 113 | 152 | 102 | 94  | 32 | M-8 |
| 50 | 50 | 35 | 228 | 50 | 121 | 171 | 115 | 117 | 40 | M-8 |
| 63 | 63 | 32 | 245 | 47 | 123 | 170 | 122 | 117 | 50 | M-8 |

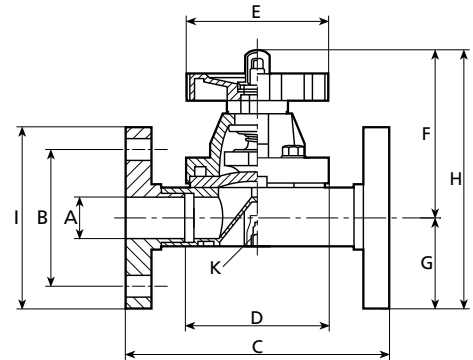

| Ø  | A  | B   | C   | D   | E   | F   | G  | H   | I   | K   |
|----|----|-----|-----|-----|-----|-----|----|-----|-----|-----|
| 20 | 15 | 67  | 130 | 73  | 82  | 91  | 49 | 140 | 97  | M-6 |
| 25 | 20 | 73  | 150 | 83  | 82  | 96  | 53 | 149 | 106 | M-6 |
| 32 | 25 | 85  | 160 | 93  | 94  | 105 | 58 | 163 | 115 | M-6 |
| 40 | 32 | 99  | 180 | 102 | 94  | 112 | 70 | 182 | 140 | M-8 |
| 50 | 40 | 109 | 200 | 115 | 117 | 121 | 75 | 196 | 150 | M-8 |
| 63 | 50 | 122 | 230 | 122 | 117 | 128 | 82 | 210 | 164 | M-8 |

GRÁFICO DE PERDIDAS DE CARGA  
 PRESSURE LOSS GRAPHIC  
 GRAPHIQUE DE PERTE DE CHARGE

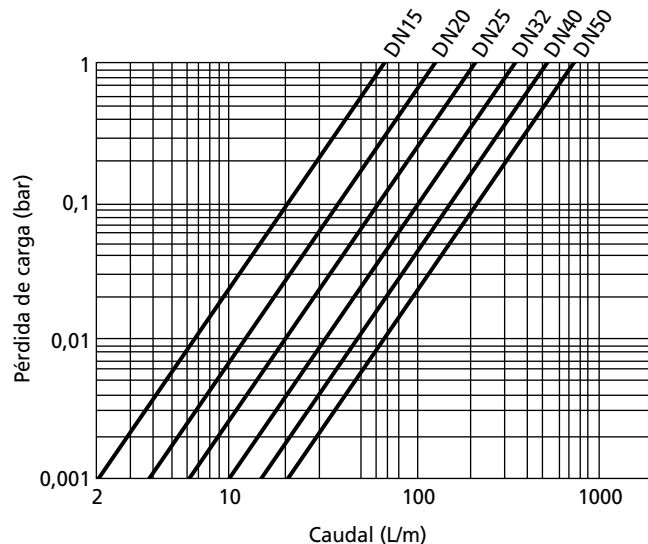

VALORES PAR MANIOBRA EN VOLANTE  
 OPERATING TORQUE VALUES  
 VALEUR DE COUPLE

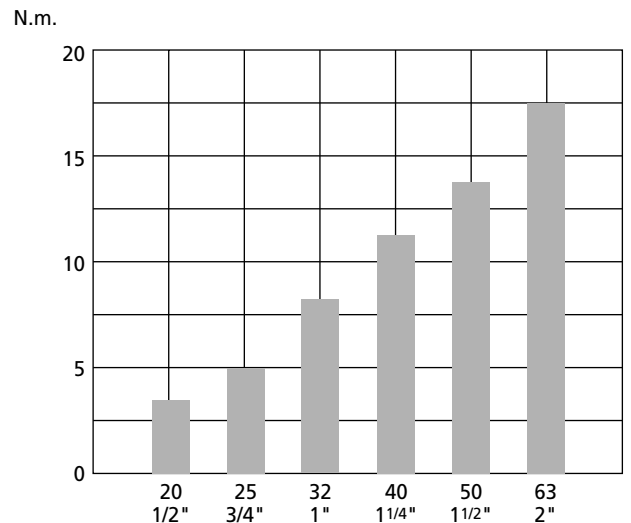

CARACTERÍSTICAS:

- Desmontaje de un manguito de la válvula estando cerrada y en servicio, desmontaje del cuerpo radial.

CONDICIONES DE TRABAJO:

- Temperatura máxima 60°C. PN 10 bar

PRUEBA:

- Hidráulica según normas UNE-EN 917

CHARACTERISTICS:

- Demounting sleeve of a valve were closed and in service, radial demounting of the body.

WORK CONDITIONS:

- Maximum temperature 60°C. NP 10 bar

TESTING:

- Hydraulic in accordance with UNE-EN 917

CARACTERISTIQUES:

- Désassemblage d'un manchon de la vanne etant fermée et dans service, désassemblage de le corp radial.

CONDITIONS DE TRAVAIL:

- Température maxime 60°C. PN 10 bar

ESSAI:

- Hydraulique selon les normes UNE-EN 917