



Serie **WAFER-SPLIT PN16...**

Articolo **763000**

STAINLESS STEEL

Wafer Split full bore flanged ball valve, PN16, Fire Safe, Antistatic Device.

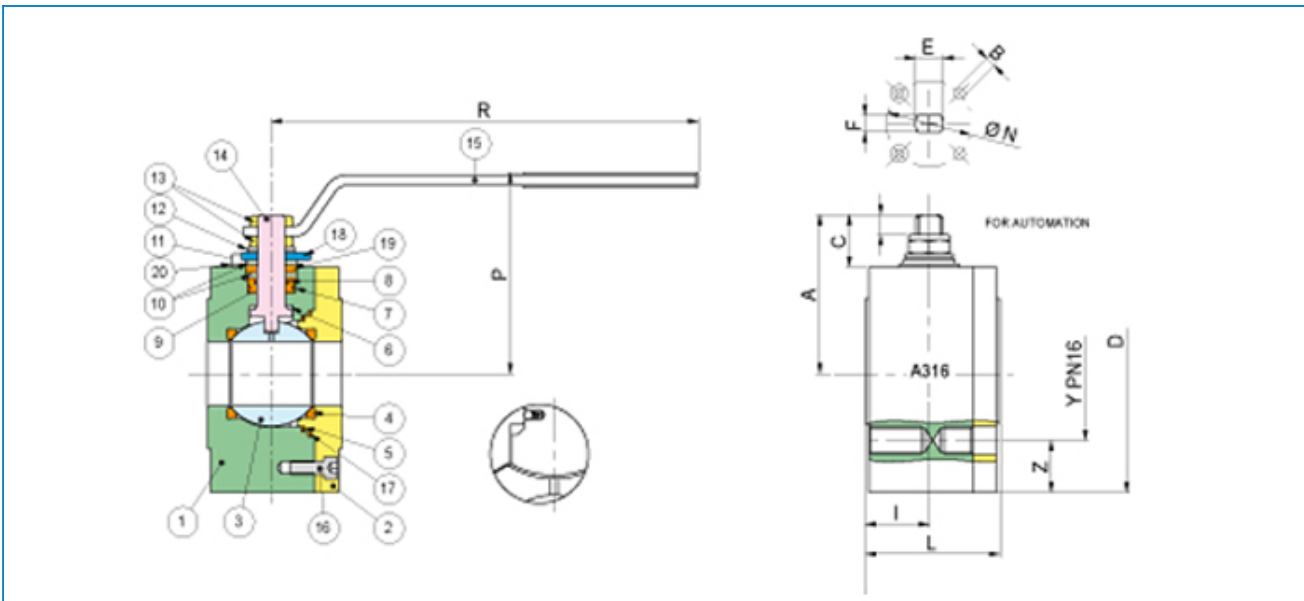

Limiti di temperatura: -20° +160° - Temperature range: -20° +160° Vuoto: 10-3 torr. - Vacuum: 10-3 torr.

POS.	PART NAME	MATERIALE-MATERIALS MATERIAUX-WERKSTOFF- MATERIAL	N°P
1	BODY	A182 - F316L	1
2	END CONNECTION	A182 - F316L	1
3	BALL	A351-CF8M/ A182-F316	1
4	BALL SEAT	P.T.F.E.	2
5	BODY SEAT	P.T.F.E.	1
6	THRUST WASHER	P.T.F.E.	1
7	RING	FKM (VITON)	1
8	RING	FKM (VITON)	1
9	STEM SEAT	P.T.F.E.	1
10	PACKING GLAND	A182 - F316	2
11	SCREW	STAINLESS STEEL	2
12	SPRING WASHER	A182-F304	4
13	NUT	STAINLESS STEEL	2
14	STEM	A182 - F316	1
15	HANDLE	A182 - F316	1
16	SCREW	STAINLESS STEEL	3-4
17	BODY SEAT	GRAPHOIL	1
18	90° STOP	A182 - F316	1
19	STEM SEAL	GRAPHOIL	1
20	WASHER	STAINLESS STEEL	2

MISURA SIZE	DN	D	Y	Z	I	L	R	P	A	C	T	E	F	ØN	B	Kv	PN	Kg
1/2"	15	90	65	4 x M12	22	53	131	69	52,5	19,5	8	M10	7	42-F04	M5	16,3	40	2,30
3/4"	20	95	75	4 x M12	22	53	131	74	56	18	7,5	M10	7	42-F04	M5	29,5	40	2,45
1"	25	110	85	4 x M12	24	57	174	92	72,5	25,5	10	M12	8	42-F04	M5	43	40	3,80
1"1/4	32	130	100	4 X M16	30	65	174	97	76	23	8,5	M12	8	42-F04	M5	89	40	5,60
1"1/2	40	140	110	4 X M16	37,5	79	250	118	93	31	11	M16	10	50-F05	M6	230	40	8,50
2"	50	150	125	4 X M16	42	84	250	126	102	31	11,5	M16	14	50-F05	M6	265	40	10,00
2"1/2	65	180	145	4 X M16	50,5	103	321	143	121	37,5	17	M20	14	70-F07	M8	540	16	17,50
3"	80	190	160	8 X M16	61	122	381	153	132	42	18	M24	18	70-F07	M8	873	16	27,50
4"	100	220	180	8 X M16	77,5	155	381	166	145,5	43	18	M24	18	102-F10	M10	1.320	16	36,80

MISURE 5" - 6" - 8" ART. 721000 ART. 722000 - SIZE 5" - 6" - 8" ART. 721000 - ART. 722000



Serie **WAFER-SPLIT PN16...**

Articolo **764000**

CARBON STEEL

Wafer Split full bore flanged ball valve, PN16, Fire Safe, Antistatic Device.

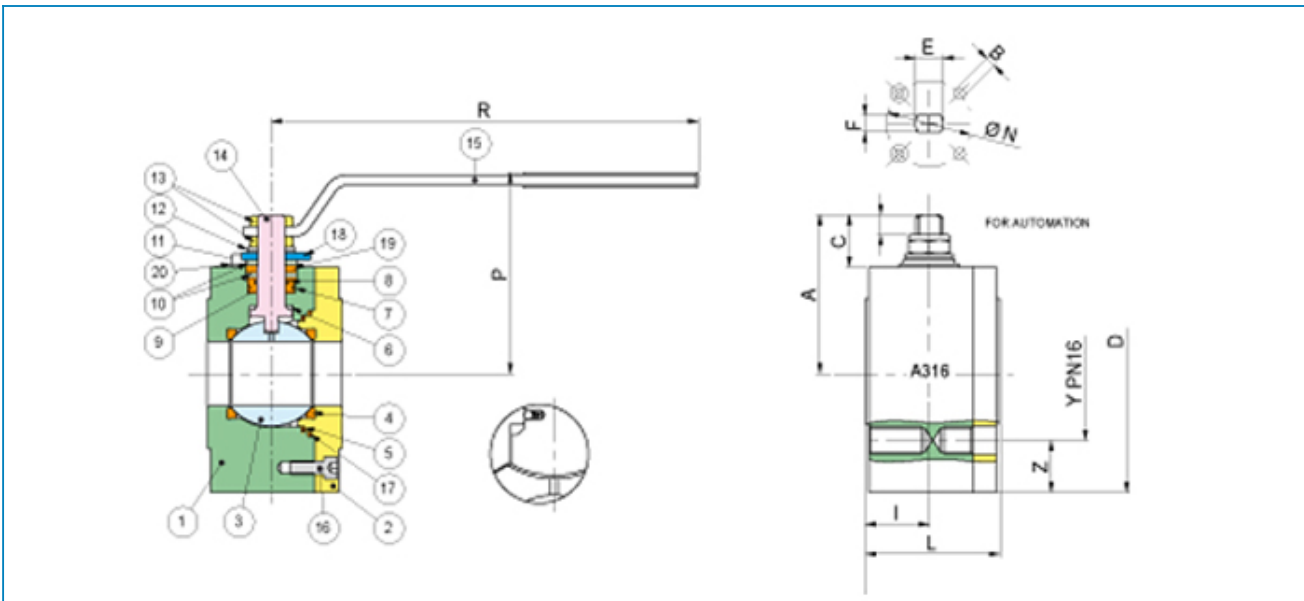

Limiti di temperatura: -10° +160° - Temperature range: -10° +160° Vuoto: 10-3 torr. - Vacuum: 10-3 torr.

POS.	PART NAME	MATERIALE-MATERIALS MATERIAUX-WERKSTOFF- MATERIAL	N°P
1	BODY	ASTM A105	1
2	END CONNECTION	ASTM A105	1
3	BALL	A351-CF8/ A182-F304	1
4	BALL SEAT	P.T.F.E.	2
5	BODY SEAT	P.T.F.E.	1
6	THRUST WASHER	P.T.F.E.	1
7	RING	FKM (VITON)	1
8	RING	FKM (VITON)	1
9	STEM SEAT	P.T.F.E.	1
10	PACKING GLAND	A182 - F316	2
11	SCREW	CARBON STEEL	2
12	SPRING WASHER	CARBON STEEL	4
13	NUT	CARBON STEEL	2
14	STEM	A182 - F304	1
15	HANDLE	CARBON STEEL	1
16	SCREW	CARBON STEEL	3-4
17	BODY SEAT	GRAPHOIL	1
18	90° STOP	CARBON STEEL	1
19	STEM SEAL	GRAPHOIL	1
20	WASHER	STAINLESS STEEL	2

MISURA SIZE	DN	D	Y	Z	I	L	R	P	A	C	T	E	F	ØN	B	Kv	PN	Kg
1/2"	15	90	65	4 x M12	22	53	131	69	52,5	19,5	8	M10	7	42-F04	M5	16,3	40	2,30
3/4"	20	95	75	4 x M12	22	53	131	74	56	18	7,5	M10	7	42-F04	M5	29,5	40	2,45
1"	25	110	85	4 x M12	24	57	174	92	72,5	25,5	10	M12	8	42-F04	M5	43	40	3,80
1"1/4	32	130	100	4 X M16	30	65	174	97	76	23	8,5	M12	8	42-F04	M5	89	40	5,60
1"1/2	40	140	110	4 X M16	37,5	79	250	118	93	31	11	M16	10	50-F05	M6	230	40	8,50
2"	50	150	125	4 X M16	42	84	250	126	102	31	11,5	M16	14	50-F05	M6	265	40	10,00
2"1/2	65	180	145	4 X M16	50,5	103	321	143	121	37,5	17	M20	14	70-F07	M8	540	16	17,50
3"	80	190	160	8 X M16	61	122	381	153	132	42	18	M24	18	70-F07	M8	873	16	27,50
4"	100	220	180	8 X M16	77,5	155	381	166	145,5	43	18	M24	18	102-F10	M10	1.320	16	36,80

MISURE 5"- 6"- 8" ART. 721000 ART. 722000 - SIZE 5"- 6"- 8" ART. 721000 - ART. 722000